



Mutelcor LoRaHUB

MTC-LH01

Quick Start Guide



Thank you for choosing Mutelcor GmbH.
We are proud to be part of your project

1. Need Help?

For any other query related to our product, please contact the local distributor or Mutelcor at support@mutelcor.com.

2. Manufacturer

Mutelcor GmbH: An der Bastei 42a, 47259 Duisburg, Germany

Office: +49 203 72996070, Fax: +49 203 72996071, Web: www.mutelcor.com

3. Safety

Read the instructions carefully before device installation, operation and maintenance

1	Connect the adapter to a properly wired and grounded electrical outlet
2	The device should only be used with accessories or spare parts supplied by your reseller
3	The device enclosure must not be opened when connected to power
4	Maintenance and repair must be carried out by qualified personnel authorized by reseller
5	Keep the device away from any hot surface or outdoor environment

4. Product Description

Mutelcor LoRaHUB is designed to enable quick connection of LoRa-based Wireless devices with Mutelcor LoRaWAN Server in an indoor environment. It connects to WiFi networks and offers a unique and cost-effective implementation of LoRa-based IoT Solutions.

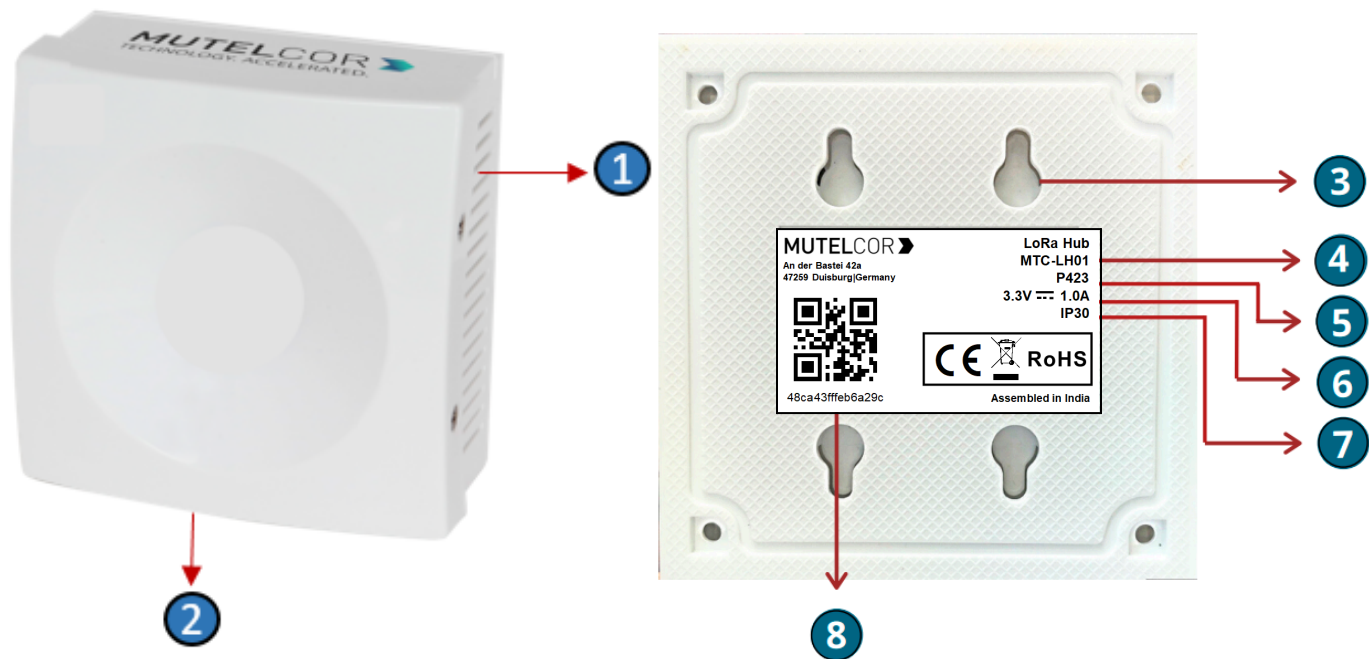

At a Glance

No.	Description	No.	Description
1	Multi-color LED Indicator	5	Module ID
2	Jack Connector (for power adapter)	6	Power supply Input (3.3V =1A)
3	Oblong Holes for Wall Mount	7	Ingress Protection
4	Model Name	8	LoRaHUB EUI with QR code

5. Technical Specifications

Model No.	MTC-LH01	Operating Temperature	-10°C to +55 °C
LoRaWAN Server	Mutelcor LNS Only	Power Supply	3.3V DC, 1A Power-Adapter (included)
LoRa Channels	One Channel	Dimensions (L x W x H)	95 mm x 95 mm x 48 mm
LoRa Frequency Band	IN 865	Net Weight	120g
Receiver Sensitivity	-136 dBm	IP Rating	IP 30 (Indoor-Use only)
Tx Power	+22 dBm	Type Approval	RoHS & Reach
WiFi Frequency Band	2.4 GHz Operating	Manufacturer	Mutelcor GmbH

6. Connect to WiFi Network

1. **Switch-on Mutelcor LoRaHUB to connect to WiFi:** Plug the adapter into a wall outlet to power it. Locate the LoRaHUB WiFi network using the WiFi setting on your phone, select '**MTC LoRaHUB-XXXXX**' (where 'XXXXX' is its unique ID mentioned on the device's label) from the list of available networks, and use the password **mutel123** to connect to the WiFi network as shown in Figure 5.1

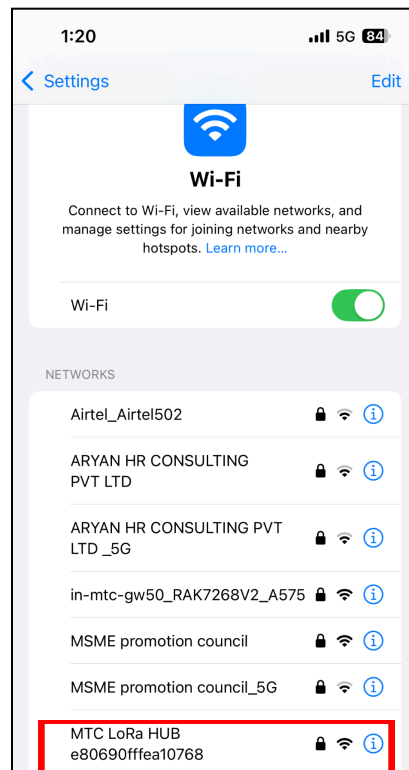

Fig.5.1

2. **Open the configuration page:** After connecting to LoRaHUB WiFi Network, a web setup page should automatically open in your phone's browser. If the web page does not open automatically, please enter the local IP-Address **172.17.2.1** manually.

3. **Choose your existing WiFi network to connect Mutelcor LoRa Network Server:**

A list of available WiFi networks will appear. Configure your existing WiFi network by selecting its SSID and entering the password, as shown in Fig. 5.2.

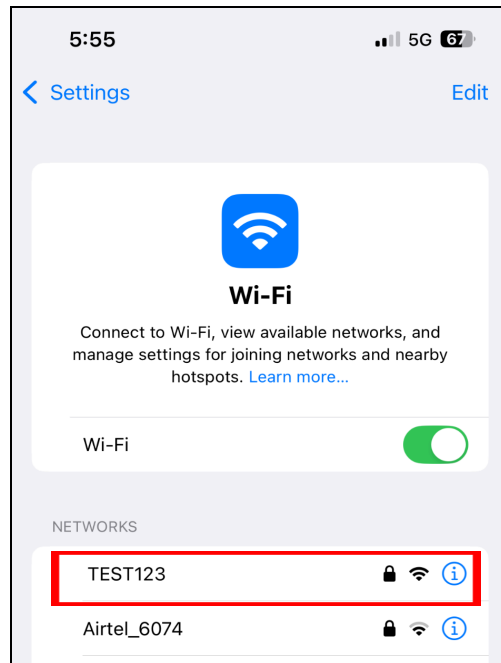

Fig.5.2

4. **Confirmation:** A confirmed message '**Success!**' will be shown on the web-page when the LoRaHUB has successfully connected to your WiFi as shown in Fig. 5.3

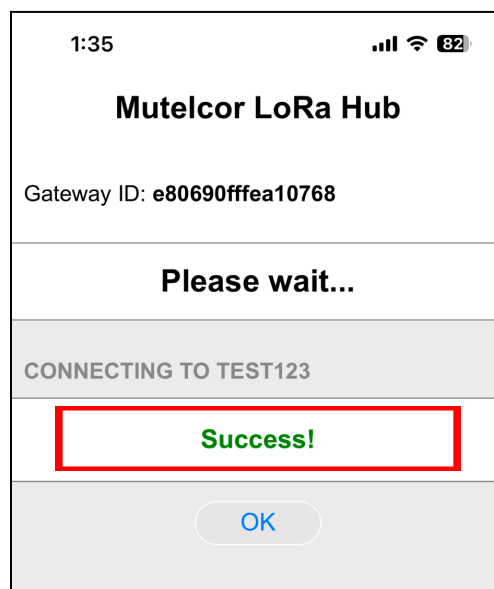

Fig.5.3

7. How to change WiFi Network

1. **Activate LoRaHUB WiFi Hotspot**

To activate the LoRaHUB WiFi Hotspot mode, make sure that the LoRaHUB disconnects from the previously configured and connected WiFi network. This can be achieved either by deactivating the existing WiFi network or moving the LoRaHUB to a location out of the WiFi coverage. As soon as the LED starts blinking Blue, the LoRaHUB has enabled the WiFi Hotspot.

2. **Configure new WiFi Network**

Once in WiFi Hotspot mode, follow the steps mentioned in Chapter 5 for configuring and connecting to a new WiFi network.

3. **Re-activate existing WiFi network**

In case a WiFi was de-activated to enable the WiFi Hotspot mode on the LoRaHUB, it can now be activated again.

8. LED Indication Status

 **Green: Status: Online:** LoRaHUB is successfully connected to Mutelcor LoRa Network Server.

 **Blinking Blue: Status: Offline with LoRaHUB's own WiFi Hotspot is active:** LoRaHUB WiFi Hotspot is activated. The LED has two colors: Blue and the one of the above colors (Magenta, Cyan, White or Green) indicating the respective state of the Hub.

 **Red: Status: Offline with Power On:** LoRaHUB is disconnected with no WiFi and no Internet. The Hub is powered on and is trying to connect to a WiFi network for internet connectivity.

In case the LED remains red for more than 2 minutes, please change the WiFi network as mentioned in chapter 6.

 **Violet: Status: Offline with WiFi Connectivity only:** LoRaHUB is successfully connected to a WiFi network but still does not have a working Internet connection.

In case the LED does not change to Cyan, White and Green, please check if the WiFi network has a working internet connection or change the WiFi network as mentioned in chapter 6.

 **Cyan: Status: Online with WiFi and Internet Connectivity:** LoRaHUB is successfully connected to WiFi and Internet but is not yet connected to Mutelcor LoRa Network Server.

In case the LED does not change to White or Green, please check if the WiFi network has a working internet connection or change the WiFi network as mentioned in chapter 6.

 **White: Status: Online and Connecting to Mutelcor LNS:** LoRaHUB is WiFi and Internet connected and is trying to connect to Mutelcor LoRa Network Server.

In case the LED does not change to green, please restart the Hub by disconnecting it from the power and waiting for at least 30 seconds before re-connecting it to the power. After the restart the issue should be resolved. In case the issue persists, please contact the local distributor or Mutelcor GmbH at support@mutelcor.com.

 **Blinking Red: Status: Critical Error:** LoRaHUB is blinking rapidly (5 times per seconds). The Hub has encountered an error which prevents it from functioning correctly. Please restart the Hub by disconnecting it from the power and waiting for at least 30 seconds before re-connecting it to the power. After the restart the issue should be resolved. In case the blinking persists, please contact the local distributor or Mutelcor GmbH at support@mutelcor.com.

No Color: Status: Offline without Power: LoRaHUB is powered off. Check the Power connection.

9. Disposal / Recycling

	Do not dispose of the product with household waste. For proper disposal, contact a waste disposal company WEEE-Reg.-Nr.: DE 71445608
---	--

10. Product complies and Directives



11. Find us on social media

We would like to hear from you: any tips, any news to share?

 www.facebook.com/mutelcor

 Mutelcor GmbH

We stay at your disposal for any help on your project

Mutelcor GmbH Team



Learn More

For complete product information
Scan QR code or Visit

www.mutelcor.com